

# REZNOR®

Our Technology. Your Comfort



## PVE

Gas Fired Floorstanding Power Vented Heaters

**Warm air heaters**

Radiant heating ~ Air curtains ~ Controls ~ Heating & ventilation units ~ Destratification fans





# PVE

## Power Vented Cabinet Heaters

The PVE range of gas fired atmospheric cabinet heaters are suitable for a wide variety of commercial and industrial applications.

Suitable for free blowing applications PVE can be supplied with the optional adjustable discharge nozzle assembly.

For ducted air installations PVE units are supplied complete with a duct outlet spigot.

### Applications

- > Factories
- > Horticulture
- > Greenhouses
- > Showrooms
- > Warehouses
- > Workshops

### Model Range

The PVE cabinets are available in six heat outputs from 35kW to 137kW.

Modulating burner is fitted as standard to each model, which is operated by the Smartcom MZ control panel fitted to each heater. Should the Smartcom not be required, then the burner will require a 0 to 10v DC signal to operate.

All units are available for natural gas (G20) as standard, but alternatively can be specified for use on Propane (G31).

## Specification

### Heat Exchanger Burner

Titanium stabilised aluminised steel heat exchanger for enhanced life expectancy.

### Burner

Advanced burner technology utilises a single self-aligning burner, with multi-try ignition for optimum reliability and ease of maintenance

### Electric Motors

All electric motors comply with EC motor directive 2005/32/EC

### Air Distribution

Double inlet centrifugal fans circulate large air volumes evenly across the heat exchanger to give low surface temperatures and optimised heat transfer.

Free blowing units are supplied complete with aerodynamic discharge nozzles for extended throws. Nozzles are complete with horizontal louvres and may be rotated through 360° to ensure good air distribution.

### Cabinets

Manufactured from electro zinc coated steel the cabinet is finished in a stove hardened epoxy powder paint finish to provide a robust and durable case. For safety and aesthetics all controls are fully enclosed behind a full width hinged access door fitted to the front of the heater.

### Controls

Units are supplied complete with SmartCom, an integral fully optimised electronic time and temperature control system with password protection facility.

## Installation

Units should be installed on a flat noncombustible base capable of supporting the unit weight and ensuring that the recommended clearances for correct airflows and service access are observed.

Consideration must also be given to the route and length of the flue, and if required the ducted combustion air inlet.

## Versatile Flue Installation

Heaters are fitted with an integral flue fan and are CE certified to be used as either balanced flue room sealed or fan assisted appliances.

The balanced flue terminals provide both the flue outlet and combustion air inlet.

Where heaters are installed without connection to combustion air pipe work, adequate provision must be made for combustion air ventilation.

The integral flue fan permits both roof and wall terminations and allows the heater to be sited several metres away from the flue exit.

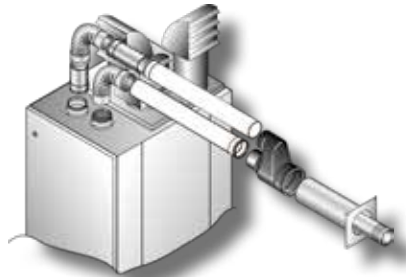

Balanced flue wall outlet (type C12) eliminates expensive roof opening and flashing



Balanced flue roof outlet (type C32)

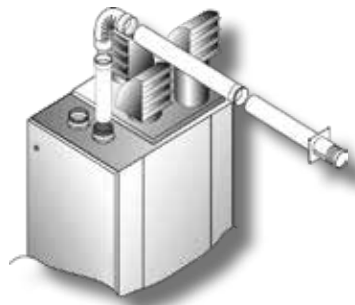

Fan assisted flue through wall (type B22) without combustion air pipe eliminates expensive roof opening and flashing

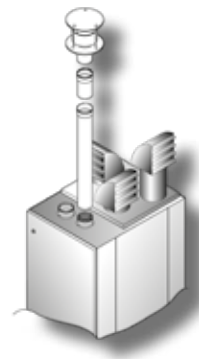

Fan assisted flue through roof (type B22) without combustion air pipe

Technical Data		Model Ref					
		PVE30	PVE50	PVE72	PVE95	PVE120	PVE145
Nominal heat output	kW	35	49	73	95	129	137
Airflow	m <sup>3</sup> /h	2,880	3,780	5,400	8,280	10,980	13,176
Temperature rise	°C	36	38	40	34	34	30
Throw <sup>1</sup> (PVN)	m	18	19	19	26	29	26
Static pressure	Pa	80	110	100	130	100	50
<b>Gas Consumption</b>							
Natural gas G20	m <sup>3</sup> /h	3.99	5.59	8.39	11.06	14.81	16.78
Propane G31	m <sup>3</sup> /h	1.50	2.20	3.20	4.30	5.70	6.50
Gas connection <sup>2</sup>	Rc	½"	½"	¾"	¾"	1"	1"
Min Gas Inlet Pressure Nat gas G20	mbar	17.5	17.5	17.5	17.5	17.5	17.5
Propane G31	mbar	37.0	37.0	37.0	37.0	37.0	37.0
<b>Electrics</b>							
Supply	V/ph hz	230/1/50	230/1/50	230/1/50	230/1/50	230/1/50	230/1/50
Electrical load	W	1,250	1,900	1,850	2,900	3,100	3,400
Flue & combustion air diameter	mmø	100	100	130	130	130	130
Maximum vertical run <sup>4</sup>	m	9	9	9	9	9	9
Nozzles (PVN)	no.	2	2	3	3	3	4
Noise level <sup>3</sup>	dB(A)	63	67	64	74	74	76
Net weight (PVN)	kg	205	221	277	324	409	444

1. Throw is dependent on building height, room temperature and nozzle settings.
2. Gas lines must be adequately sized and reduced at appliance as required.
3. Noise levels measured at 3 metres from appliance. Noise levels at 5 metres available on request.
4. Reduce distance by 1.0m for every 90° elbow & 0.8m for 45° elbow.

## Dimensions

		Model Ref					
		PVE30	PVE50	PVE72	PVE95	PVE120	PVE145
Unit height	A	1625	1625	1705	1805	1855	1855
Unit width	B	697	697	864	864	1347	1347
Unit depth	C	1079	1079	1232	1232	1242	1242
Gas connection position	D	831	831	908	1171	982	979
Gas connection position	E	232	232	232	232	262	262
Duct outlet connection	F	570	570	766	766	1213	1213
Duct outlet connection	G	570	570	784	784	767	767
Nozzle outlet PVN	N	324	324	352	352	415	415
Nozzle outlet PVN	P	n/a	n/a	677	677	800	800
Flue & combustion air connections	Ø	100	100	130	130	130	130
Installation clearance - front		700	700	840	840	840	840
Installation clearance - side		150	150	150	150	150	150
Installation clearance - rear		400	400	400	400	400	400

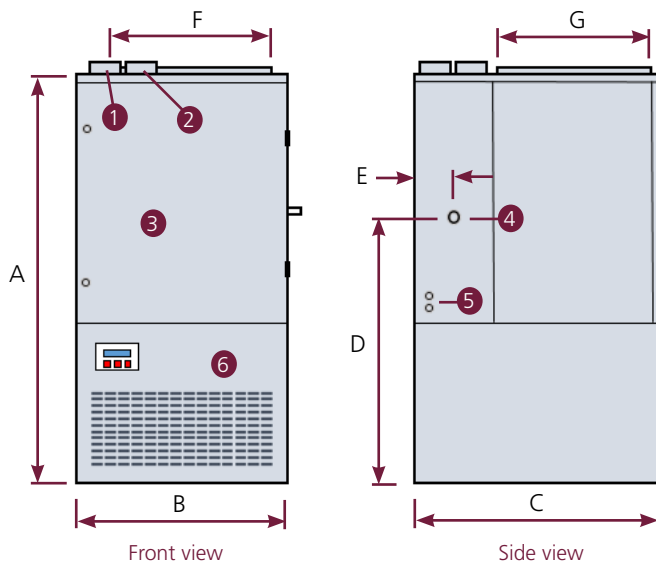

Front view

Side view

1. Flue connection (model 95, 120 & 145 only)
2. Combustion air inlet (model 95, 120 & 145 only)
3. Service door
4. Gas connection
5. Electrical connections
6. Fan section

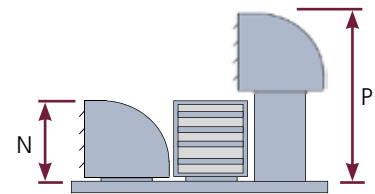

Units with more than 2 nozzles are supplied as standard with height extensions for rear nozzles. Standard nozzles may be specified for height sensitive applications or installations where cabinets are located centrally within the space.

Models  
30 & 50

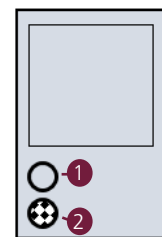

Front

Model  
72

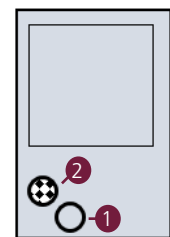

Front

**Flue & combustion air connections  
for models 30 to 72**

GB/REZ/PVE/01/1019